

USER MANUAL

使用說明書

HAENIM SMART FLEX

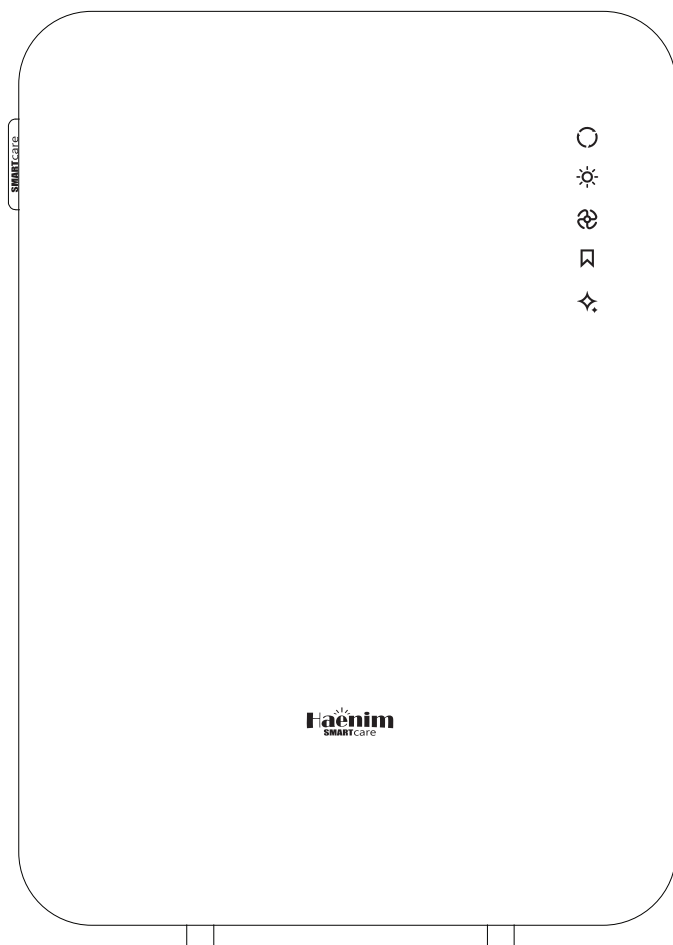

Haenim[®]
SMARTcare

產品規格

產品名稱	Haenim喜臨UV LED消毒烘乾機(尊尚系列)
型號	HN-F5
款式	座檯式
額定電壓(V)/額定頻率(Hz)	AC 220V, 50/60Hz
總額定消耗電功率	95W
烘乾/消毒方式	內置型PTC加熱器/ UVC LED
尺寸	295(W) x 375(D) x 425(H) mm
重量	淨重 5kg

使用前，請仔細閱讀本使用說明書，並妥善保存以備將來參考。

如果本產品有任何問題，請參閱本使用說明書。

內容

使用前	安全注意事項	4
使用方法	產品概要	6
	產品使用說明	7
保養方法	清潔及UV LED水盆使用說明	9
服務	FAQ	10
	產品保用登記	20

安全注意事項

警告

若忽略此說明可能會導致產品故障或使用者受傷。

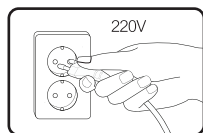

本產品僅與220V 50/60Hz電壓相容。不正確的使用可能會導致觸電或起火。

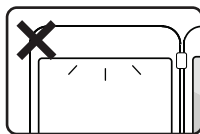

請勿在門打開的情況下強行開着UV LED。

強烈的UV光會對眼睛有害。

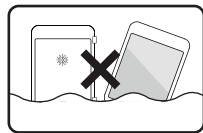

切勿將本產品浸入水中，也不要嘗試拆卸零件。

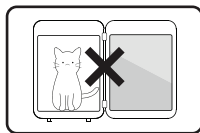

請勿在本產品中放置動物或不能受熱的產品，例如塑膠、油漆稀釋劑或苯。這可能會導致觸電或起火。

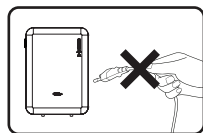

請勿在產品運作途中拔除電源線。

這可能會導致觸電或起火。

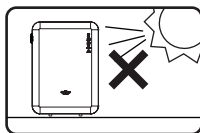

請將本產品放在平坦的表面上，並避免陽光直射。

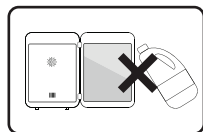

定期清潔時請勿使用氯化物的清潔產品(例如漂白劑)，因為它會腐蝕不銹鋼部件。

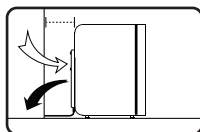

在放置本產品時不要完全緊貼牆邊，請在背面預留足夠空間以保持氣流出入暢順。

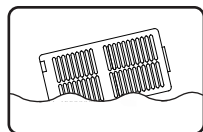

建議每月用水清洗隔塵網，並在瀝乾後安裝回去。

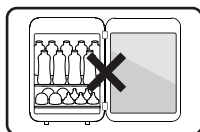

請勿在本產品內放置超過建議量的物品，因為會降低消毒效能。

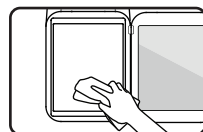

建議每月清潔不銹鋼內部。

安全注意事項

⚠ 危險

若忽略此說明可能會導致重傷或死亡的危險。

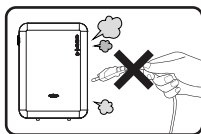

若在使用過程中有燃燒的氣味，請停止使用產品、立即中斷電源並致電技術支援。

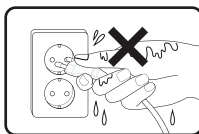

手濕的時候請勿使用電源插座。

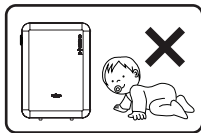

請將本產品和電線放在兒童接觸不到的地方，以防觸電或物體掉落。

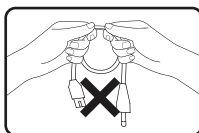

請勿用力彎曲或拉扯電源線。

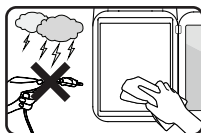

在閃電或雷雨天氣清潔本產品時，請先拔除電源線。



請用乾布清潔電源線。



請勿在浴室、溫泉或游泳池等濕度高的地方使用本產品。

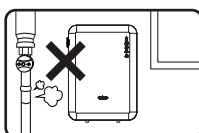

如果懷疑有氣體洩漏，請停止使用本產品，並且保持室內通風。

產品概要

零件介紹

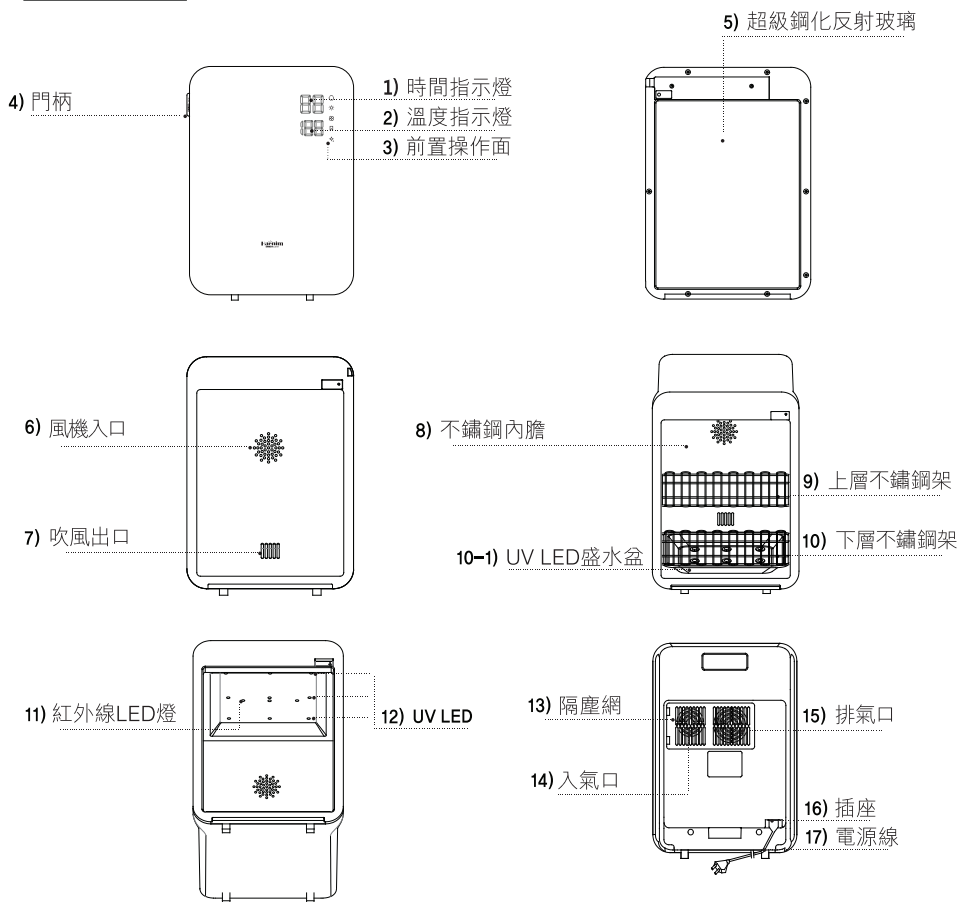

附屬零件

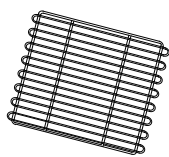

上層不鏽鋼架

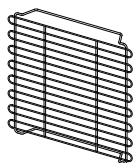

下層不鏽鋼架

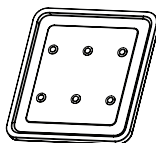

UV LED盛水盆

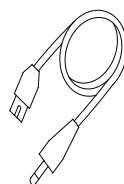

電源線

產品使用說明



自動模式

先烘乾後消毒的方式，可選擇「自動模式」1~3

按下AUTO按鈕一次：
烘乾20分鐘、消毒10分鐘（同時吹風30分鐘）
總共運作30分鐘

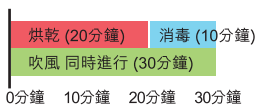

按下AUTO按鈕兩次：
烘乾40分鐘、消毒10分鐘（同時吹風50分鐘）
總共運作50分鐘



按下AUTO按鈕三次：
烘乾60分鐘、消毒10分鐘（同時吹風70分鐘）
總共運作70分鐘

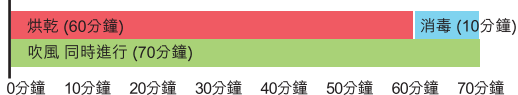

消毒模式

只進行消毒的模式，可選擇「消毒模式」1~2

按下UV LED按鈕一次：
消毒10分鐘（同時吹風10分鐘）
總共運作10分鐘

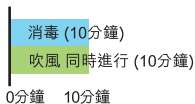

按下UV LED按鈕兩次：
消毒20分鐘（同時吹風20分鐘）
總共運作20分鐘

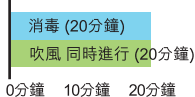

加速模式

先以高效烘乾後消毒，可選擇「加速模式」1~3

按下TURBO按鈕一次：
烘乾20分鐘、消毒10分鐘（同時吹風30分鐘）
總共運作30分鐘



按下TURBO按鈕兩次：
烘乾40分鐘、消毒10分鐘（同時吹風50分鐘）
總共運作50分鐘



按下TURBO按鈕三次：
烘乾60分鐘、消毒10分鐘（同時吹風70分鐘）
總共運作70分鐘

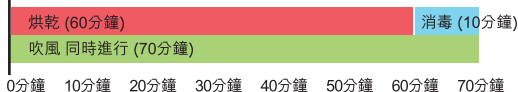

產品使用說明



智能儲存模式

STORAGE

進行24小時保溫及儲存的模式。每3小時進行1次「自動模式1」- 包括烘乾20分鐘、消毒10分鐘(同時吹風30分鐘)，合共30分鐘。每3小時1次，一共8次循環。

建議先選擇(自動 / 加速 / 消毒)模式，再按下STORAGE按鈕，當完成以上模式，3小時後便會開始進行第1次循環。

啟動「智能儲存模式」後，每3小時進行1次循環：
烘乾20分鐘、消毒10分鐘(同時吹風30分鐘)
總共運作30分鐘

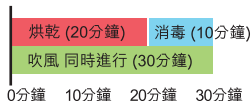

在「智能儲存模式」下，若中途開關機門，將會自動進行消毒1分鐘(同時吹風1分鐘)



清潔模式

CLEAN

清潔提醒功能，消毒烘乾機累計使用60小時後，提示燈亮起，將內部清潔後，按一下「清潔模式」，就會自動重置。



自然烘乾模式

Tip

長按加速模式(TURBO) 5秒，可切換至「自然烘乾模式」(PTC 加熱器會暫停運作)，可選擇「自然烘乾模式」1~3

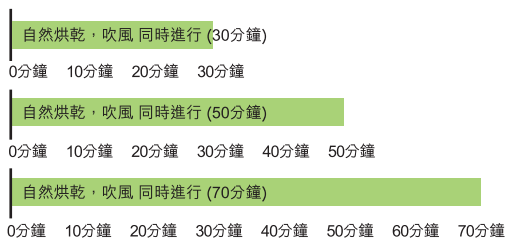

加速烘乾模式

Tip

先按「加速模式」(TURBO) 1次，然後長按「消毒模式」(UV LED) 5秒，便可切換至「加速烘乾模式」(UV LED 消毒會暫停)，可選擇「加速烘乾模式」1~3

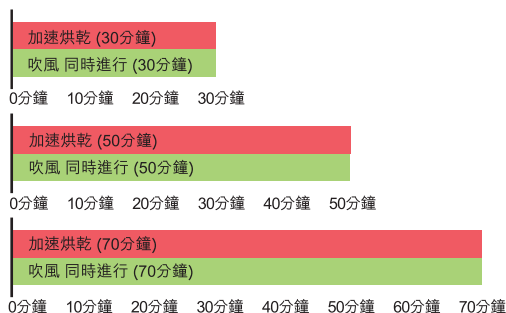
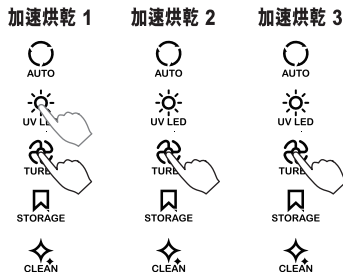

靜音模式

Tip

按住「自動模式」(AUTO)按鈕5秒鐘能夠進入「靜音模式」。

UV LED盛水盆清潔及使用說明

UV LED盛水盆

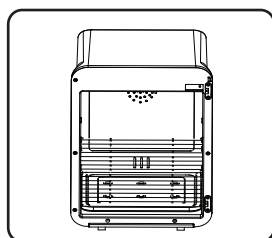
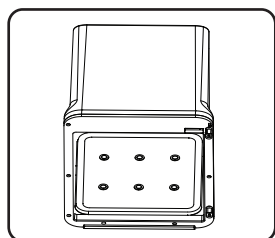
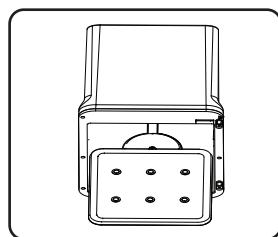
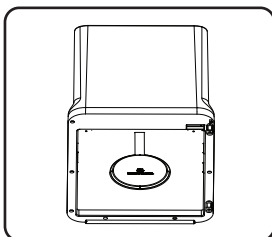
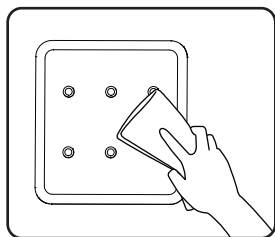

1. 用乾布擦拭盛水盆
2. 將水盆放置於中間的無線充電口
3. 將下層層架放置於水盆上方，而上層層架則放在上面(如上圖)

外部清潔

使用中性和清潔劑和軟布清潔消毒器的外部，然後再用乾布清潔。

內部清潔

清潔頻率因用戶而異，但建議每月清潔一次以上。本產品的清潔功能有助於計算下次清潔時間。

當收到清潔功能的提醒時，請卸下內部零件並用濕布清潔內部，然後用乾布擦拭。

清潔內部後，請按“清潔”按鈕重置。

※ 請在清潔前拔掉主電源線。

FAQ(常見問與答)

請在維修之前，先參閱下面的常見問與答。

問題	解答
時間顯示UE是什麼意思？	Haenim消毒機有9個UV LED燈泡。 若偵測器發現其中一個UV LED燈泡故障，時間指示燈就會顯示UE提醒用家。請聯絡技術支援中心以安排保養。
按鍵時沒有發出聲效！	按住“ AUTO” 按鈕五秒鐘能夠進入靜音模式。此功能對於對聲音敏感的嬰兒十分有用。 再次按住“ AUTO” 按鈕五秒鐘能夠退出靜音模式。如果問題仍然存在，請聯絡技術支援中心。
我需用什麼清潔內部？	可以一杯水加十滴醋去製作天然清潔劑，並將其噴塗在不鏽鋼內膽，再用乾淨的布擦拭。 建議每周清潔一次，請在清潔後將門打開一段時間，以保持不鏽鋼內膽它乾爽通風。
如何棄置消毒機？	如果您想棄置Haenim消毒機，請勿自行拆卸或嘗試將其放入一般垃圾桶或回收箱中。 請致電您當地的衛生服務中心並諮詢協助。

Specifications

Product	Haenim Smart UV Sterilizer, SMART FLEX
Model	HN-F5 Series
Type	Free Standing type
Voltage	AC 220V, 50/60Hz
Consumption	95W
Drying/Sterilizing	PTC Heater / UVC LED
Size	295x375x425 mm
Weight	5kg(net)

- Before use, please read this manual carefully and save it for future reference.
- In the case of any problems with this product, please refer to this manual.
- Please save this manual as it contains the product warranty.

CONTENTS

Precautions	Safety instructions	13
Use Methods	Product overview	15
	User guide	16
Maintenance	Cleaning and UV tray use	18
Service	FAQ	19
	Warranty service	20

SAFETY INSTRUCTIONS

⊘ Caution

Disregarding instructions can potentially lead to risk of product malfunction and minor injuries.

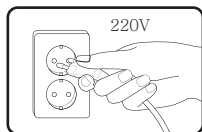

This product is compatible with 220V 50/60Hz voltage use only
Incorrect use may result in electric shock or fire.

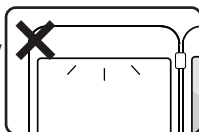

Do not force the UV LED on with the door open.
This can be harmful to the eyes.

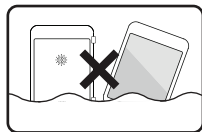

Never submerge this product in water, nor try to disassemble parts unless specified in manual.

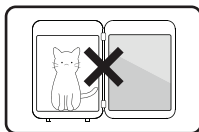

Do not place any animals in this product, nor products affected by heat such as plastic, paint thinner, or benzene.
This may result in electric shock or fire.

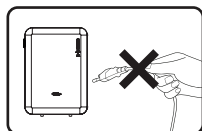

Do not pull the main cord out by force while product is in use.
This may result in electric shock or fire.

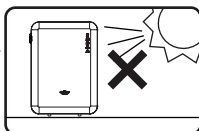

Place this product on a flat surface and out of direct sunlight.

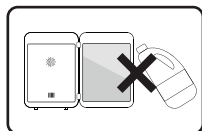

Do not use chloride-based cleaning products (eg. bleach) as it can corrode the stainless steel components.

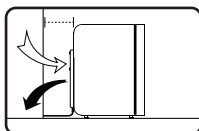

Give this product enough room in the back for the inflow and outflow through the rear filter.

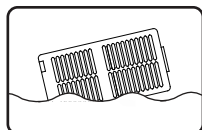

Filter cleaning with water is recommended once a month.

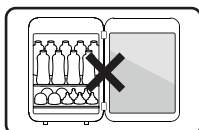

Do not place more than the recommended amount of items inside this product as it can decrease sanitizing capabilities.

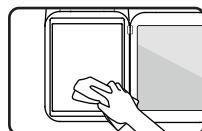

Descaling the stainless steel interior is recommended once a month.

SAFETY INSTRUCTIONS

Danger

Disregarding instructions can potentially lead to risk of major injuries or fatalities.

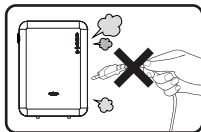

If there is a burning smell during use, stop product use and immediately disconnect the cord and call customer service.

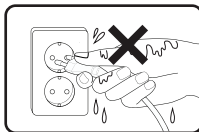

Do not plug in or out of electrical sockets when hands are wet.

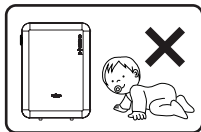

Keep this product and cords out of reach of children to prevent risk of electric shock or falling objects.

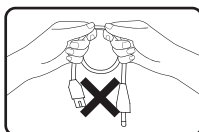

Do not forcefully bend or pull the main cord.

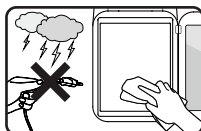

Disconnect the main cord when cleaning this product in weather with lightning or thunder



Clean the main cord with a clean, dry cloth.



Do not use this product in places with high humidity, such as bathrooms, saunas or swimming pools.

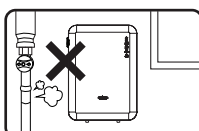

If there is suspicion of gas leaks, stop using this product and air out the surrounding areas.

PRODUCT OVERVIEW

Parts Guide

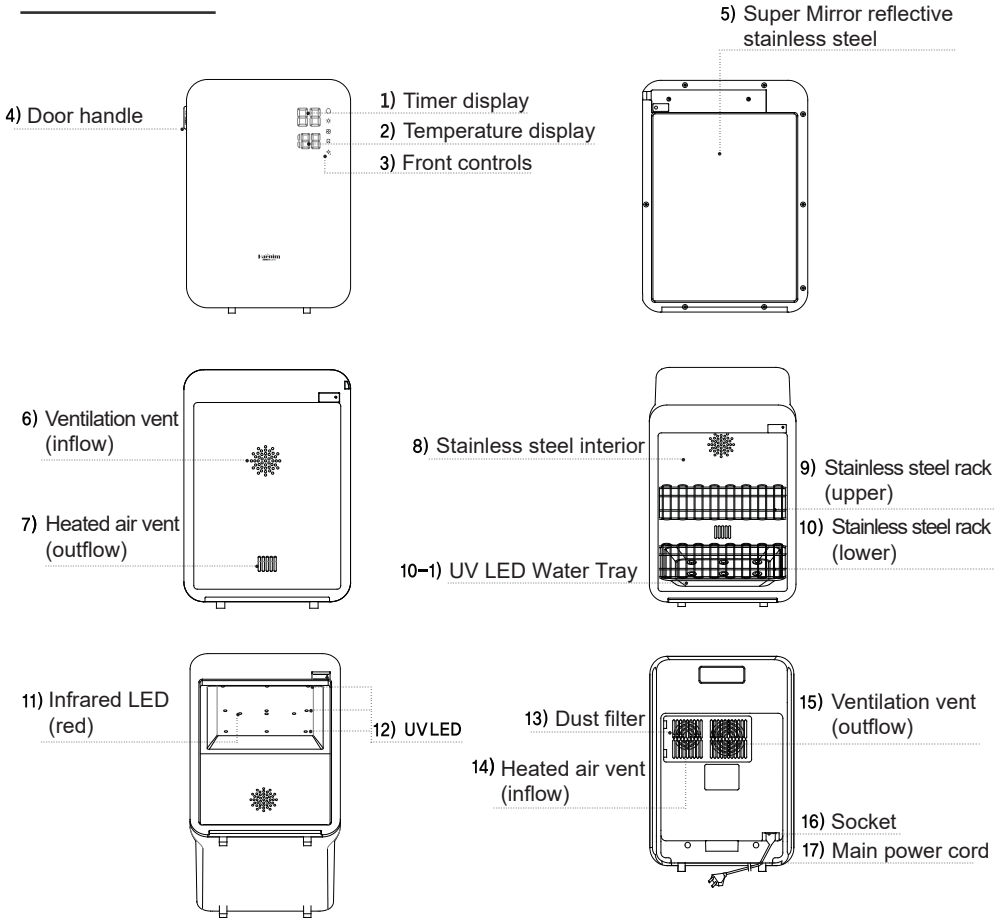

Accessory Components

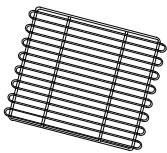

Stainless steel rack (upper)

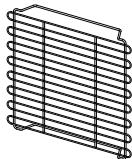

Stainless steel rack (lower)

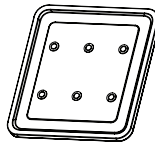

UV LED water tray

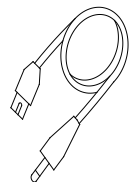

Main power cord

USER GUIDE



AUTO button

Transfers automatically between drying, sterilizing functions; 3 cycles available (Auto 1~3)

Touch Auto button one time :

Dry 20 min, Sterilize 10 min (Ventilate 30 min),

Total 30-min runtime

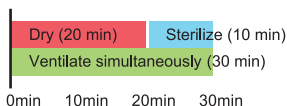

Touch Auto button two times :

Dry 40 min, Sterilize 10 min (Ventilate 50 min),

Total 50-min runtime

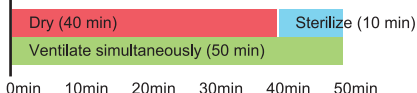

Touch Auto button three times :

Dry 60 min, Sterilize 10 min (Ventilate 70 min),

Total 70-min runtime



UV LED button

Separate sterilizing function; 2 cycles available (Sterilize 1~2)

UV LED

Touch UV button one time :

Sterilize 10 min (Ventilate 10 min),

Total 10-min runtime

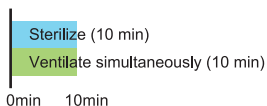

Touch UV button two times :

Sterilize 20 min (Ventilate 20 min),

Total 20-min runtime

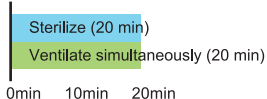

TURBO button

Extra strong drying function, and sterilization; 3 cycles available (Turbo 1~3)

TURBO

Touch Turbo button one time :

Dry 20 min, Sterilize 10 min (Ventilate 30 min),

Total 30-min runtime

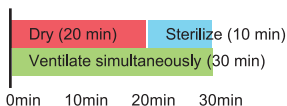

Touch Turbo button two times :

Dry 40 min, Sterilize 10 min (Ventilate 50 min),

Total 50-min runtime

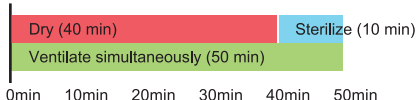

Touch Turbo button three times :

Dry 60 min, Sterilize 10 min (Ventilate 70 min),

Total 70-min runtime



USER GUIDE

STORAGE button

Use for longer storage times; button allows for automatic cycles of AUTO 1 mode every 3 hours, for up to 24 hours.

Suggest to press (AUTO/ UV LED/ TURBO) button first, and then press STORAGE button. When selected mode is completed, Smart Storage cycle will begin in 3 hours.

Automatic cycles every 3 hours
 Dry 20 min, Sterilize 10 min (Ventilate 30 min)
 Total 30-min runtime.

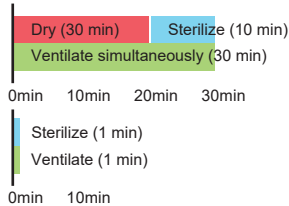

During Storage mode, opening and shutting door activates automatic sterilizing 1 min, ventilating 1 min

CLEAN button

Calculates usage 60 hours and alerts user to next cleaning; after cleaning interior, press the Clean button, show the current usage in the display.

Air-drying function

Tip

Press the Turbo button for 5 secs, Switch to the Air-drying function (PTC heater operation is stopped), 3 Cycles available (Air-drying 1~3)

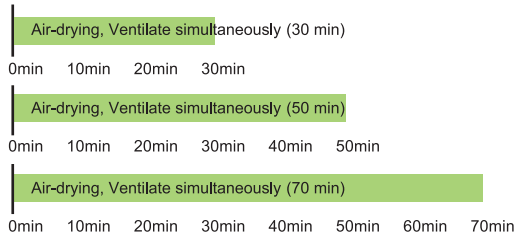

Turbo-drying function

Tip

Press the Turbo button one time then press the UV LED button for 5 secs, Switch to the Turbo-drying function (UV LED operation is stopped), 3 Cycles available (Turbo-drying 1~3)

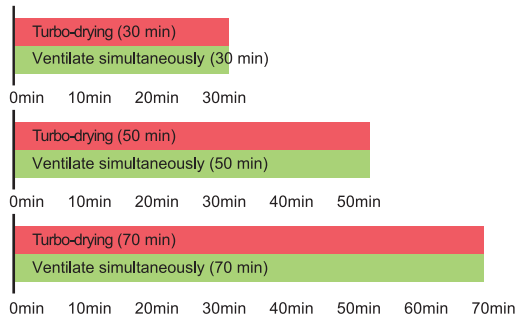
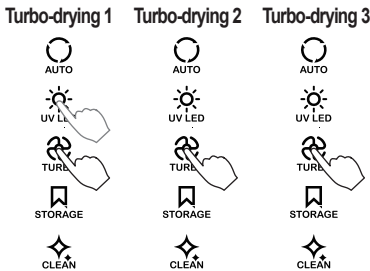

Silent Mute function

Tip

Press the Auto button for 5 secs to switch to mute mode.

UV LED WATER TRAY & CLEANING USE

UV LED WATER TRAY USE

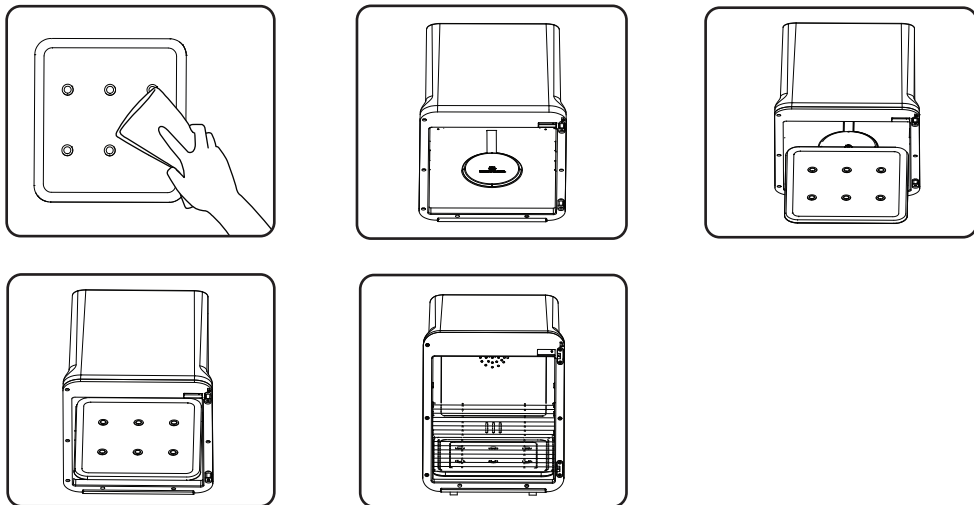

1. Clean a dry towel the UV LED water tray.
2. Place the UV LED water tray on the center of the wireless charging case.
3. place the lower rack on the UV LED water tray, the upper rack on top as shown in diagram.

Exterior Cleaning

Use a neutral detergent and soft cloth to clean the outside of the sterilizer, then clean with a dry cloth.

Interior Cleaning

Frequency of cleaning varies according to users, but more than once a month is recommended.

The Clean function of this product will assist in approximating next time of cleaning.

When alerted by the Clean function, remove interior components and clean the inside with a wet cloth, then wipe down with a dry cloth.

After cleaning the inside, press the Clean button to reset.

※ **Please disconnect the main power cord before cleaning.**

FAQ (Frequently asked questions)

Please refer to the FAQs below before requesting servicing.

Question	Answer
What does UE mean on the timer display?	The Haenim Bottle Sterilizer has 15 UV LED bulbs. In the case that even one of the bulbs do not work, a sensor will activate and alert the user on the display with UE. Contact the service center for maintenance.
The buttons don't make any sounds!	If the AUTO button is pressed for five seconds, the mute function is activated. This is useful for households with infants who are sensitive to noise. The buttons can be muted by pushing the AUTO button firmly for 5 seconds. If the problem persists, please call the service center.
What do I clean the interior with?	A cup of water with 10 drops of vinegar is a natural detergent that can be used. Spray the interior with this solution, then wipe with a soft, clean cloth. Cleaning once a week is recommended and after cleaning, remember to leave the door open for a short while to fully ventilate the sterilizer.
How do I get rid of the sterilizer?	If you would like to discard the Haenim Bottle Sterilizer, do not disassemble yourself and try to place in regular trash bins or recycling bins. Call your local sanitation services and report the product for proper disposal.

如欲參與 Haenim 喜臨之產品保養服務計劃，必須於購買後十四天內，填妥下列表格，連同購買單據副本，寄回港豐遠東有限公司。

- Haenim 喜臨之香港總代理 - 港豐遠東有限公司，將提供 Haenim 喜臨之產品首年免費保養 (購買日起計)及兩年 UV LED 燈免費保養。
- 保養及維修並不包括人為疏忽而導致之任何損壞。
- 保養服務表格之影印本恕不接受。如提供不正確資料，此表格作廢。
- 網上保養登記: <http://www.haenim.hk>
- 請保留此部份及購買單據正本以作日後保養之用。

Please complete and return the below warranty form within 14 days after purchasing the product with a copy of purchasing invoice.

- We, Kingsford Far East Ltd., the sole agent of Haenim, in Hong Kong, offer first year warranty to the product (from purchasing date). And offer 2 years warranty for UV LED lamp only.
- The warranty will not cover any damages due to negligence or improper handling.
- Copy of the warranty form will not be accepted. This warranty will become null and void if any of information given below is found to be inaccurate.
- Online registration: <http://www.haenim.hk>
- Please keep this part of the form and original purchasing invoice for warranty.

香港總代理: 港豐遠東有限公司

荃灣海盛路 9 號

有線電視大樓 3902 室

電話 Tel: 2348 0433

Sole agent: Kingsford Far East Ltd.

Unit 3902, Cable TV Tower,

9 Hoi Shing Road,

Tsuen Wan, NT, Hong Kong



網上登記
www.haenim.hk

本人欲參與港豐遠東有限公司提供的 Haenim 喜臨產品保養服務計畫。

I would like to join the warranty provided by Kingsford Far East Ltd.

機身號碼 (Serial No):

HN

機身背部編印之號碼

(*必須填寫) (Mandatory)

no. shown at the back

購買日期 (Date of purchase): _____ 日(D) _____ 月(M) _____ 年(Y)

姓名 (Name): _____ 聯絡電話 (Phone no.): _____

地址 (Address): _____

購買商舖 (Shop): _____ 電郵(Email): _____

請於購買後十四天內，填妥此保養服務表格，連同認可分銷商的購買單據副本，寄回港豐遠東有限公司。

Please complete and return the form within 14 days after purchasing with a copy of purchasing invoice.